



FDC

Future Dental Care

Shervin Shariati DDS

Emergencies

Insurance

FAQ

Offers

Staff

Office



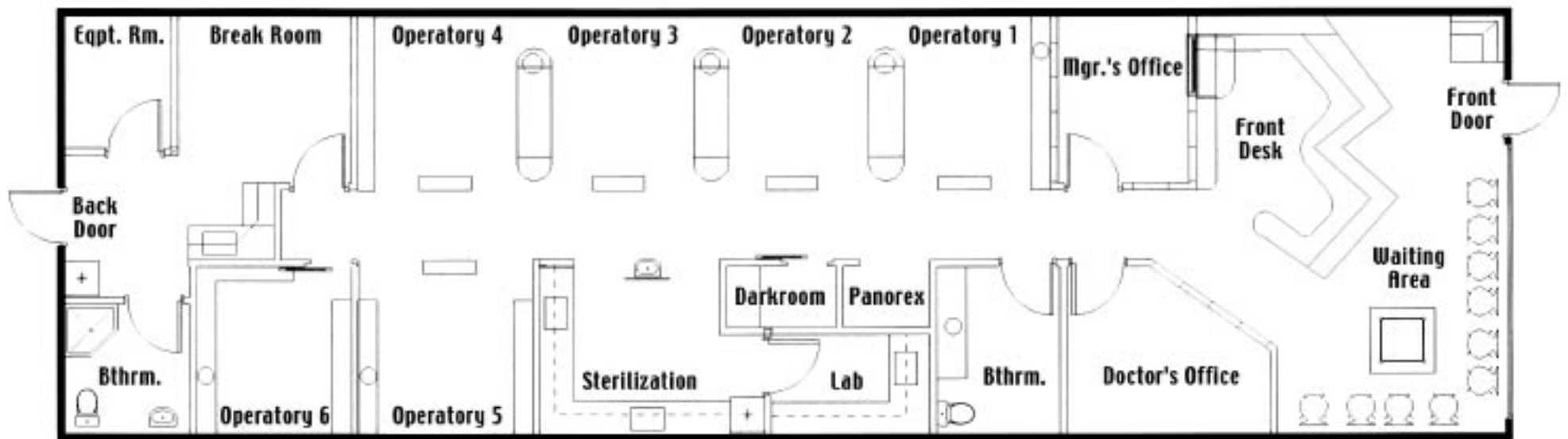

Use this Layout to Navigate the Office Photos in this Tour.



Our 2000 SF Office awaits the arrival of our Custom Outdoor Signage currently being manufactured.



**Composite Photograph of the Front Office at Future Dental Care.
The temporary furniture has been removed for these photographs.
We are currently in the process of selecting appropriate office furniture.**



Our Custom Designed Front Office is Friendly and Efficient.



A Spacious Personal Office accomodates Paperwork, Business Functions, and Privacy.



Handicap-Accessible and Chic, our Patient Bathroom is Extremely Spacious.



This is our Main Hallway looking toward the rear of the Building.



Spacious and Well-Lit, our Operator Bays afford a Comfortable, Open Environment.



Secondary Monitors allow DVD Tutorials, Entertainment, and Intra-Oral Camera Images to be Displayed Exclusively for the Patient.



Hidden Articulating X-ray Armatures can Reach Fully into Adjacent Operatories.



Ample Countertop Space is a result of Careful Planning and Efficient Floor Plan Design.



All Operatories provide Networked Access to Complete Patient Records.



Easy Inter-Operatory Access includes Strategically Located Custom Sinks.



Our Panorex Machine is situated Centrally and is Well Shielded.



Our Darkroom facilitates Efficient Film Processing and Handling.



This is the Patients' View of our Sterilization Area as they walk down our Hallway.



Our Easily Accessible Laboratory is hidden from view behind our Sterilization Area.